

# PREVENT DAMAGE

ONE SIZE  
FITS ALL

# DRIPTITE™ UNBREAKABLE Dishwasher Floor Saver Pan

*Specially Designed*  
To Fit All Dishwashers  
Enjoy the New  
Benefits & Advantages



- **WILL NEVER BREAK**
- **LIFE-LONG TOUGH**
- **Inexpensive insurance, for your expensive floors**
- Made from recycled unbreakable polyethylene plastic
- Impact-resistant (not affected by dishwasher legs or weight of machine)
- Will not allow an undetected water leak to damage your floor
- Channels water from a leak to the front of the dishwasher so immediate repairs can be done
- **Protects cabinets, subfloors, basements, and house structure from water damage**

## Tested TruTough Made to Last!



MADE IN  
U.S.A  
PRODUCT

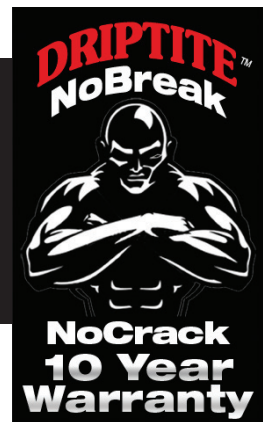

# 10 Year Warranty!

Protected by U.S. Patents Pending

### DRIPTITE 10 (ten) Year NoBreak NoCrack Warranty

If your DRIPTITE Dishwasher Pan (part) fails because of a manufacturing defect within 10 (ten) years from the date of purchase, we will provide a new part at our option, without charge. Return the defective part directly back to the A/P Office (Driptite, 25422 Trabuco Rd., Suite 105-622, Lake Forest, CA 92630) with a copy of the "proof of purchase". If the part is defective, it will be exchanged. This warranty does not cover parts that are improperly installed, damaged, abused or used for other than the intended purpose. It does not include the cost of returning the part to the vendor from which it was purchased, the labor to remove, install or diagnose the failure, parts used in the commercial applications, and incidental or consequential damage caused by possible defects with the parts.

**Disclaimer:** This product is not intended to prevent serious flooding from the plumbing for your dishwasher. It is designed to handle drips and leaks that occur with normal dishwasher usage. Please retain original shipping box until you know the pan fits and you are keeping the pan, in case of return.

Manufactured by DRIPTITE • Western U.S.: (949) 842-2387 • Eastern U.S.: (440) 265-0354  
West Coast Distribution location • 16404 Knott Ave., La Mirada, CA 90638  
Midwest Distribution location • 4920 State Road, Ashtabula, OH 44004

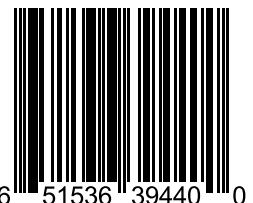

# DRIPTITE™

DISHWASHER FLOOR SAVER PAN

## Installing Your New Driptide Floor Saver Pan is Easy and Quick!



Remove your dishwasher and set it to one side. Make sure to clean up any water or mold from water damage, as well as any debris.



Squeeze a bead of DAP or silicone approximately 2" in from the edge of the dishwasher space. Alternatively, you can apply it directly to the bottom of the Dishwasher Pan, approx. 2" in from the sides.

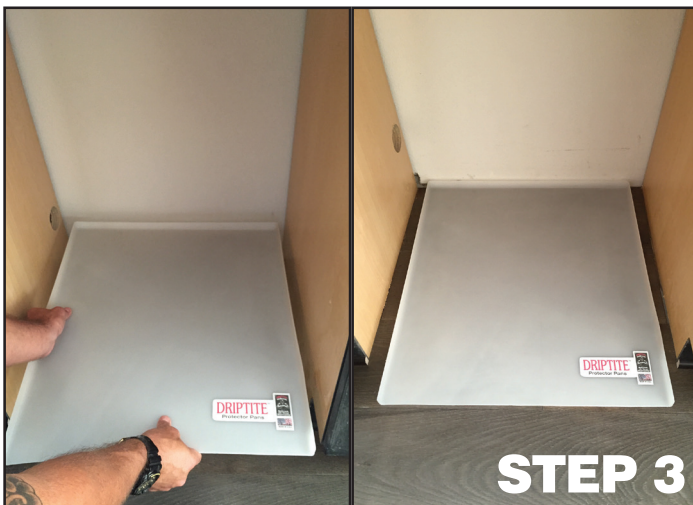

Insert the Dishwasher Pan in the space. Make sure you install the pan approximately 1/2" from the back wall. Use a tape measure to be sure you are centering the pan correctly.



\*Note: Let the Pan sit for 24 - 36 hours before re-installing your dishwasher again. This will allow for the DAP/Silicone to set up and dry. Then re-install your dishwasher, and your home is protected by DRIPTITE!

### DRIPTITE 10 (ten) Year NoBreak NoCrack Warranty

If your DRIPTITE Dishwasher Pan (part) fails because of a manufacturing defect within 10 (ten) years from the date of purchase, we will provide a new part at our option, without charge. Return the defective part directly back to the A/P Office (Driptide, 25422 Trabuco Rd., Suite 105-622, Lake Forest, CA 92630) with a copy of the "proof of purchase". If the part is defective, it will be exchanged. This warranty does not cover parts that are improperly installed, damaged, abused or used for other than the intended purpose. It does not include the cost of returning the part to the vendor from which it was purchased, the labor to remove, install or diagnose the failure, parts used in the commercial applications, and incidental or consequential damage caused by possible defects with the parts.

**Disclaimer:** This product is not intended to prevent serious flooding from the plumbing for your dishwasher. It is designed to handle drips and leaks that occur with normal dishwasher usage. Please retain original shipping box until you know the pan fits and you are keeping the pan, in case of return.